

PARAPET WALL FLASHING SURFACE TERMINATION

MULE-HIDE ALL-PURPOSE
SEALANT, NP1, GEOCEL
2300 OR OSI PR-255

TOP OF FLASHINGS MUST BE MECHANICALLY TERMINATED WITH TERMINATION BAR WITH FASTENERS SPACED 6" ON CENTER. THE FASTENERS MUST PENETRATE THROUGH THE STUCCO AND ANCHOR INTO THE STRUCTURAL WALL (CONCRETE, WOOD, ETC.) THE TOP OF THE TERMINATION BAR MUST BE SEALED WITH AN APPROVED CAULK. IF NOT INSTALLING A TERMINATION BAR, THE FLASHING MUST BE MECHANICALLY ATTACHED 8" O.C AND A METAL COUNTERFLASHING MUST BE INSTALLED TO COVER THE TOP OF THE MOD BIT FLASHING MATERIAL

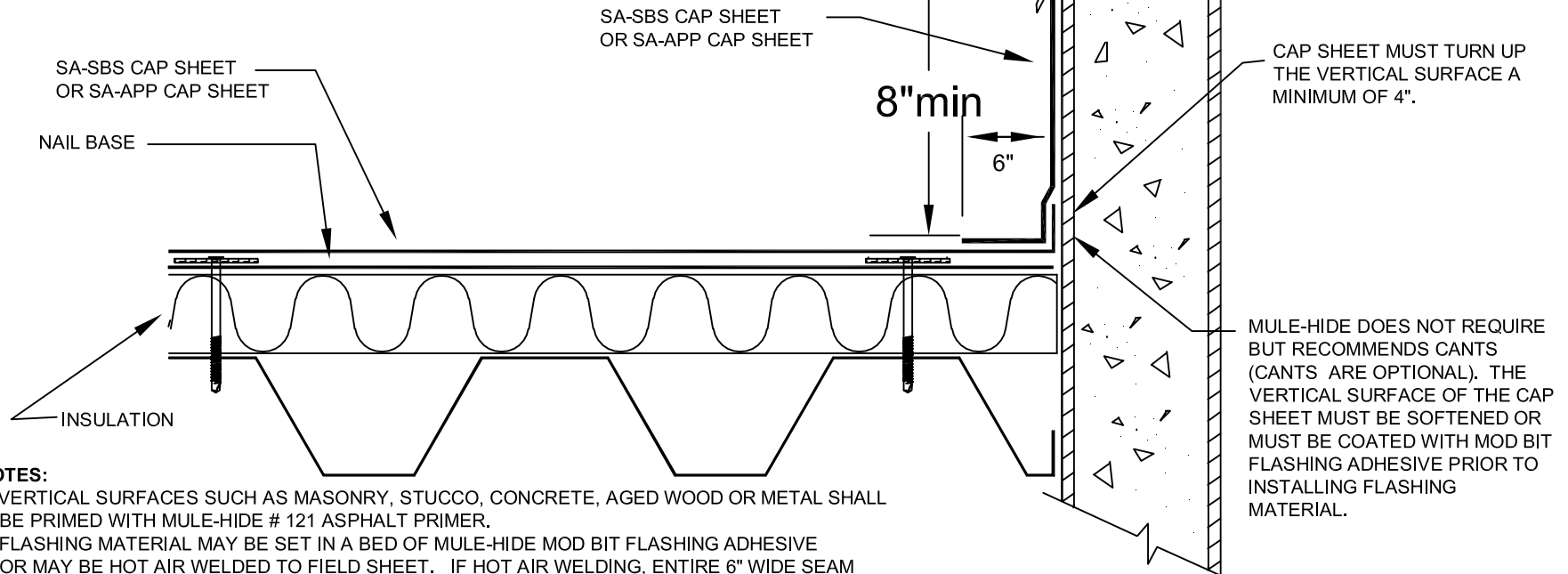

NOTES:

1. VERTICAL SURFACES SUCH AS MASONRY, STUCCO, CONCRETE, AGED WOOD OR METAL SHALL BE PRIMED WITH MULE-HIDE # 121 ASPHALT PRIMER.
2. FLASHING MATERIAL MAY BE SET IN A BED OF MULE-HIDE MOD BIT FLASHING ADHESIVE OR MAY BE HOT AIR WELDED TO FIELD SHEET. IF HOT AIR WELDING, ENTIRE 6" WIDE SEAM MUST BE SEALED.
3. INSULATION SHOULD BE MECHANICALLY ATTACHED SUFFICIENTLY TO HOLD IN PLACE PRIOR TO INSTALLING THE NAIL BASE.
4. NAIL BASE SHALL BE MECHANICALLY ATTACHED IN COMPLIANCE WITH FM ATTACHMENT GUIDELINES. THE MINIMUM ATTACHMENT PATTERN IS FM 1-60. REFER TO DETAIL: MH-MB-NB-FM 1-60.

**MULE-HIDE
PRODUCTS CO.,INC.
2003**

**BASE FLASHING - OPTION 9
SELF-ADHERING MOD BIT SYSTEMS**

**DETAIL NO.:
MH-MB-BF9**