

PARAPET WALL FLASHING HEIGHT EXCEEDING 30"

MAXIMUM WALL HEIGHT WITHOUT INTERMITTENT FASTENING IS 33" (WHEN CANTS ARE NOT INSTALLED). FOR WALLS HIGHER THAN 30", INTERMITTENT FASTENING IS EVERY 33" TO 36" MAXIMUM DEPENDING ON TYPE OF FASTENERS USED. IF ATTACHING WITH CAP NAILS THE SEAM WIDTH SHALL BE 3". IF USING INSULATION PLATES AND FASTENERS, THE SEAM WIDTH SHALL BE 6". FASTENERS SHALL BE SPACED A MAXIMUM OF 6" ON CENTER.

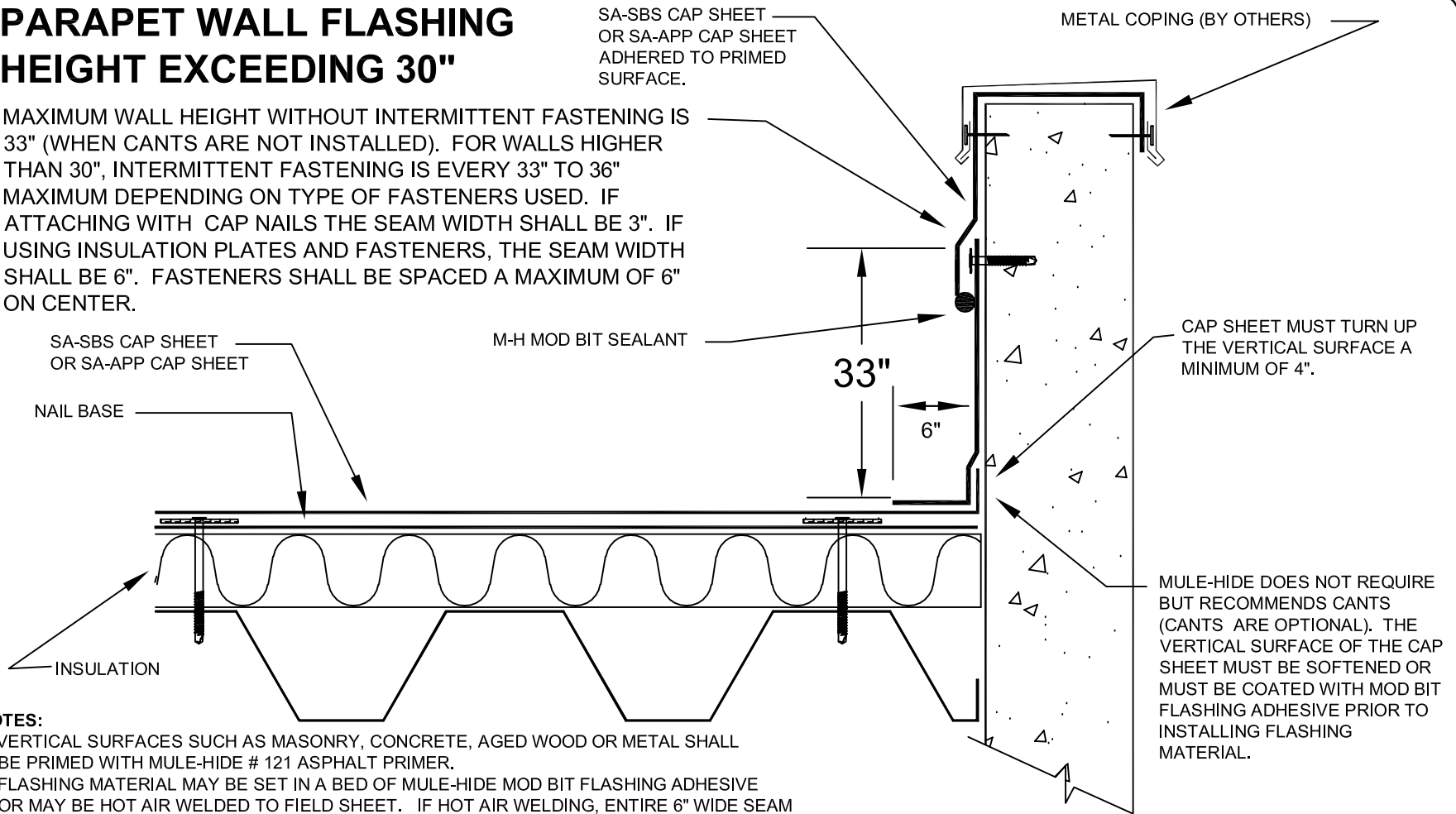

NOTES:

1. VERTICAL SURFACES SUCH AS MASONRY, CONCRETE, AGED WOOD OR METAL SHALL BE PRIMED WITH MULE-HIDE # 121 ASPHALT PRIMER.
2. FLASHING MATERIAL MAY BE SET IN A BED OF MULE-HIDE MOD BIT FLASHING ADHESIVE OR MAY BE HOT AIR WELDED TO FIELD SHEET. IF HOT AIR WELDING, ENTIRE 6" WIDE SEAM MUST BE SEALED.
3. INSULATION SHOULD BE MECHANICALLY ATTACHED SUFFICIENTLY TO HOLD IN PLACE PRIOR TO INSTALLING THE NAIL BASE.
4. NAIL BASE SHALL BE MECHANICALLY ATTACHED IN COMPLIANCE WITH FM ATTACHMENT GUIDELINES. THE MINIMUM ATTACHMENT PATTERN IS FM 1-60. REFER TO DETAIL: MH-MB-NB-FM 1-60.

**MULE-HIDE
PRODUCTS CO.,INC.
2003**

**BASE FLASHING - OPTION 6
SELF-ADHERING MOD BIT SYSTEMS**

**DETAIL NO.:
MH-MB-BF6**