

**LOW PARAPET WALL FLASHING  
HEIGHT NOT TO EXCEED 24"**

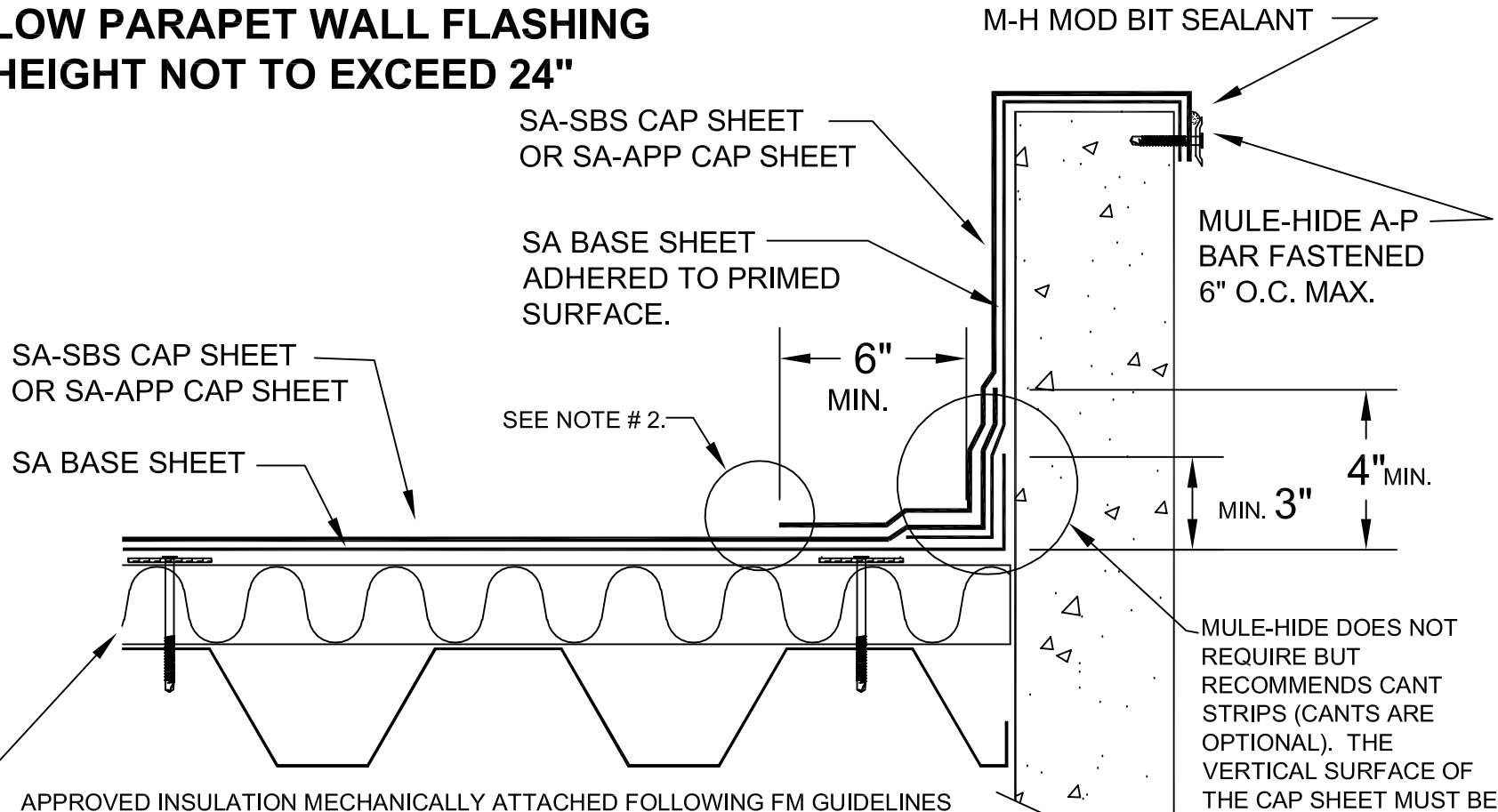

APPROVED INSULATION MECHANICALLY ATTACHED FOLLOWING FM GUIDELINES

**NOTES:**

- 1. VERTICAL SURFACES SUCH AS MASONRY, CONCRETE, AGED WOOD OR METAL SHALL BE PRIMED WITH MULE-HIDE # 121 ASPHALT PRIMER.
- 2. FLASHING MATERIAL MAY BE SET IN A BED OF MULE-HIDE MOD BIT FLASHING ADHESIVE OR MAY BE HOT AIR WELDED TO FIELD SHEET. IF HOT AIR WELDING, ENTIRE 6" WIDE SEAM MUST BE SEALED.

MULE-HIDE DOES NOT REQUIRE BUT RECOMMENDS CANT STRIPS (CANTS ARE OPTIONAL). THE VERTICAL SURFACE OF THE CAP SHEET MUST BE SOFTENED OR MUST BE COATED WITH MOD BIT FLASHING ADHESIVE PRIOR TO INSTALLING FLASHING MATERIAL.

**MULE-HIDE  
PRODUCTS CO.,INC.  
2003**

**BASE FLASHING - OPTION 2  
SELF-ADHERING MOD BIT SYSTEMS**

**DETAIL NO.:  
MH-MB-BF2**