

MULE-HIDE MATE-LINE
4" WIDE BRIDGE STRIP (metal)

Note: If using metal for bridging material, edges of metal must be hemmed with corners rounded.

MULE-HIDE EPDM
MEMBRANE

MULE-HIDE 12" CURED
COVER TAPE

MULE-HIDE TAPE
PRIMER

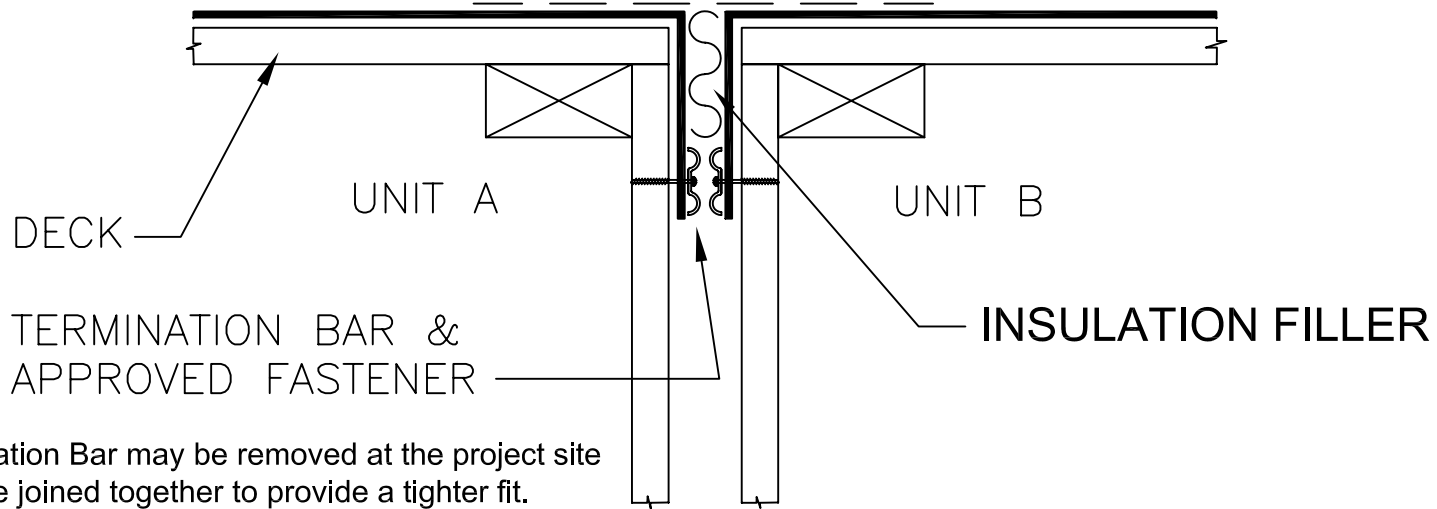

Note: Termination Bar may be removed at the project site
when units are joined together to provide a tighter fit.

**MULE-HIDE
PRODUCTS CO., INC.
2002**

MATE-LINE W/COVER TAPE
MODULAR SYSTEMS

DETAIL NO.:
MHE-302