

NOTES:

1. CLEAN THE EXISTING MEMBRANE (AND METAL IF APPLICABLE) WITH WEATHERED MEMBRANE CLEANER. PRIME THE MEMBRANE USING TAPE PRIMER. ONCE THE PRIMER IS PROPERLY DRIED, THE WHITE EPDM COVER STRIP IS APPLIED AND ROLLED USING A 2" WIDE ROLLER.
2. TREATED WOOD NAILER MUST EXTEND PAST TOTAL WIDTH OF METAL FASCIA DECK FLANGE.
3. FASTENERS AND FASTENER PATTERN AS RECOMMENDED BY METAL EDGE MANUFACTURER.
4. DECK FLANGE MUST BE TOTALLY COVERED BY WHITE EPDM CURED COVER STRIP WITH MINIMUM 2" (50 mm) COVERAGE PAST NAIL HEADS.
5. APPLY MULE-HIDE ALL-PURPOSE SEALANT ALONG BOTH EDGES OF WHITE EPDM CURED COVER TAPE AND ACROSS ENDLAPS.

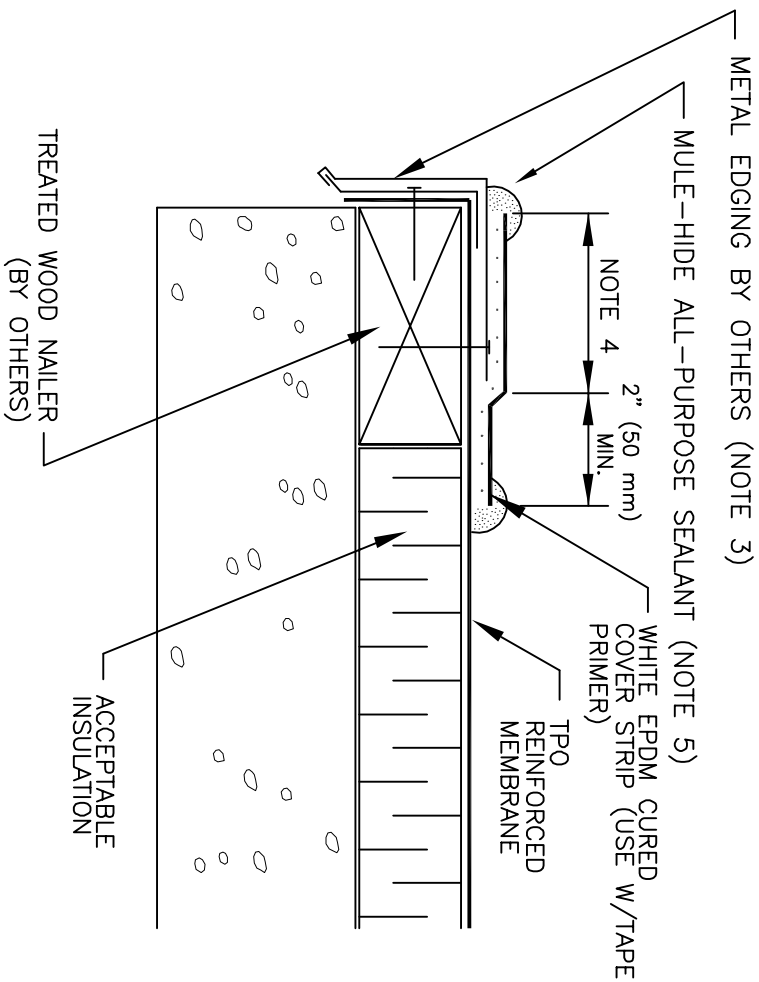
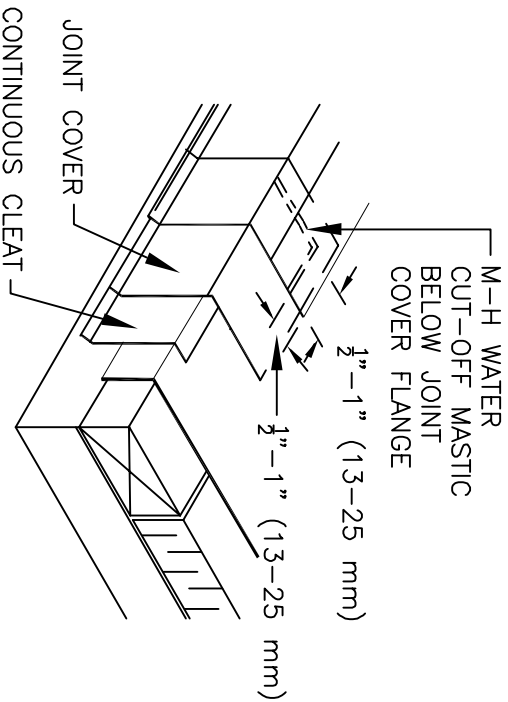

NOTE:
THIS DETAIL APPROVED FOR 20-YEAR SYSTEM WARRANTIES.

MULE-HIDE PRODUCTS CO., INC.
2009

DRIP EDGE WHITE EPDM CURED COVER STRIP SYSTEMS:
TPO ALL

DETAIL NO.:
MHT-UN-106C