

NOTES:

1. DETAILS TO BE USED IN CONJUNCTION WITH STANDARD GUIDE SPECIFICATIONS CONTAINING REQUIREMENTS FOR NAILERS, INSULATION, SLIPSHEETS, ETC.
2. PVC EDGE SEALANT IS REQUIRED ON ALL CUT EDGES OR NON-ENCAPSULATED EDGES OF REINFORCED MEMBRANE. THIS INCLUDES FACTORY CUT MEMBRANE.
3. ACCORDING TO PROJECT CONDITIONS, THE SPECIFIER AND/OR APPLICATOR MUST DETERMINE THE REQUIRED VERTICAL FLASHING HEIGHT BASED ON REGIONAL CLIMATIC CONDITIONS.
4. COATED METAL FLASHINGS MUST EXTEND UNDER A MINIMUM OF TWO (2) COURSES OF SHINGLES.
5. THE ROOFING SHEET MAY BE ATTACHED WITH APPROVED FASTENERS AND PLATES AS A BASE TIE-IN. SEE DETAIL MHP-120.
6. REFER TO MULE-HIDE UPLIFT RATINGS FOR APPROPRIATE BARBED SEAM PLATE DIAMETER FASTENER SIZE, AND SPACING.

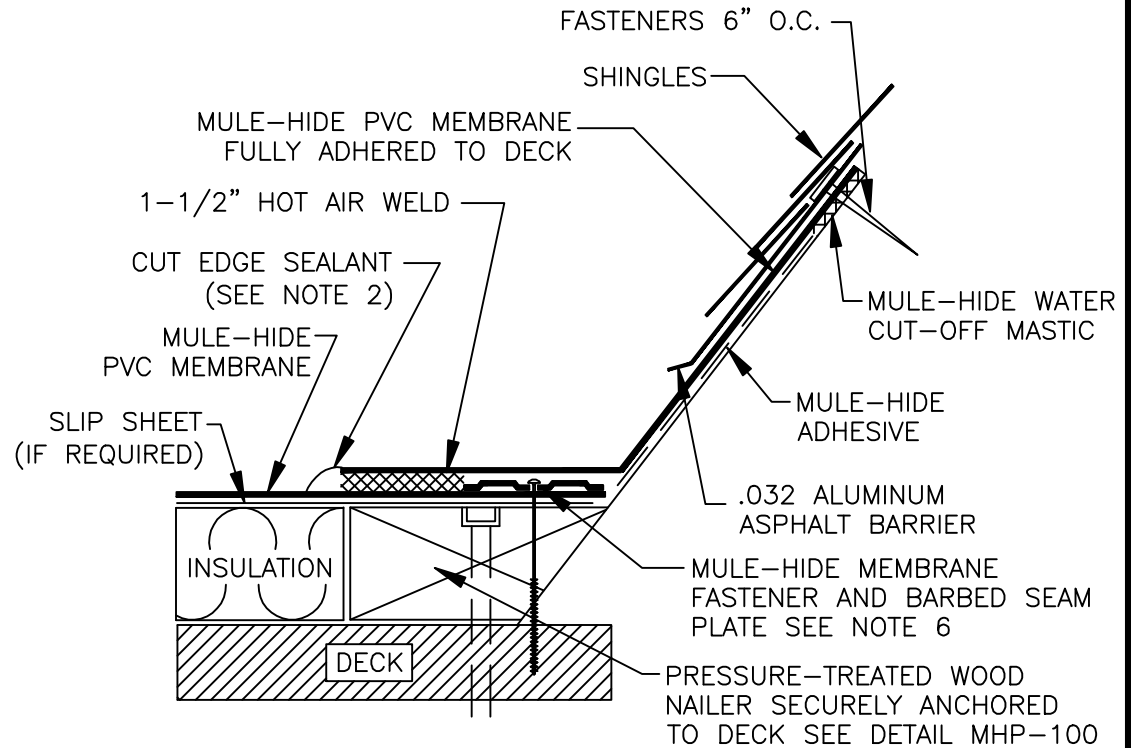

**MULE-HIDE  
PRODUCTS CO., INC.  
04/01/2007**

**MEMBRANE FLASHING  
TRANSITION TO SHINGLE ROOF  
SYSTEMS:  
ALL PVC**

**DETAIL NO:  
MHP-162**