

NOTES:

1. DETAILS TO BE USED IN CONJUNCTION WITH STANDARD GUIDE SPECIFICATIONS CONTAINING REQUIREMENTS FOR NAILERS, INSULATION, SLIPSHEETS, ETC.

2. PVC EDGE SEALANT IS REQUIRED ON ALL CUT OR NON-ENCAPSULATED EDGES OF REINFORCED MEMBRANE. THIS INCLUDES FACTORY CUT MEMBRANE.

3. POSITION BARBED SEAM PLATES 1/2" TO 1" FROM EDGE OF FIELD MEMBRANE.

4. FASTENING PLATES CAN BE INSTALLED VERTICALLY.

5. IF A WOOD NAILER IS NOT PRESENT, THE FASTENER MUST ENGAGE THE STRUCTURAL ROOF DECK.

6. REFER TO MULE-HIDE UPLIFT RATINGS FOR APPROPRIATE BARBED SEAM PLATE DIAMETER, FASTENER SIZE, AND SPACING.

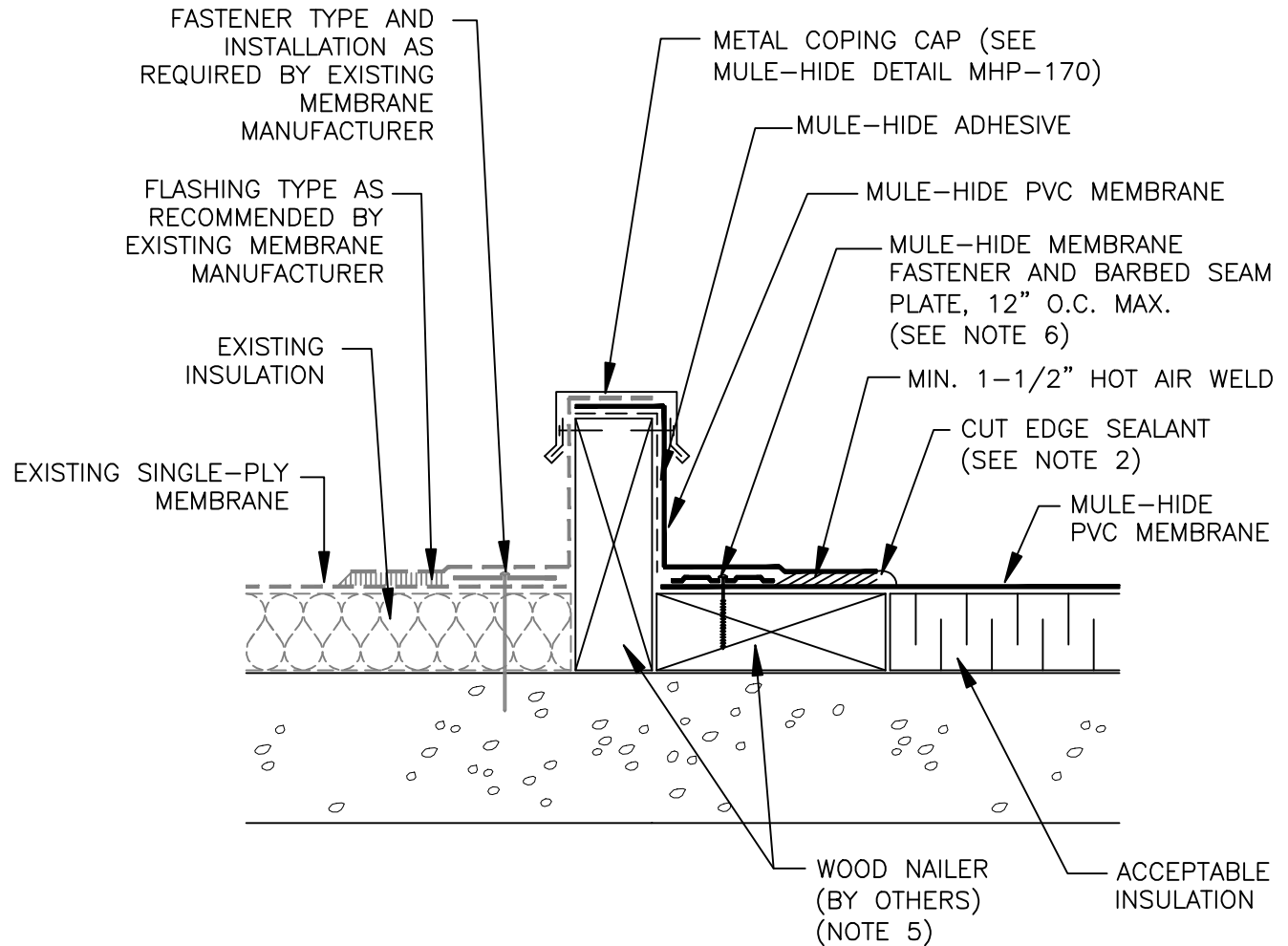

**MULE-HIDE
PRODUCTS CO., INC.
04/01/2007**

**TIE-IN TO EXISTING SINGLE-PLY
SYSTEMS:
ALL PVC**

**DETAIL NO:
MHP-160**